

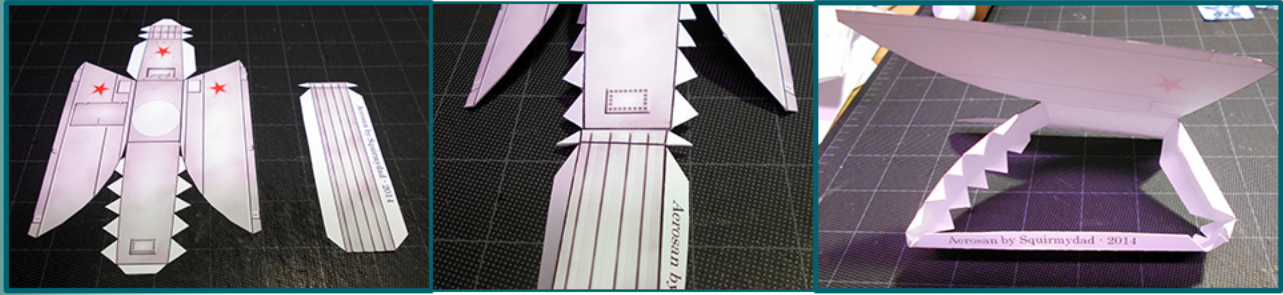

# AEROSAN - INSTRUCTIONS



**THANKS FOR DOWNLOADING THIS FREE WW2 AEROSAN MODEL!  
START BY CUTTING OUT THE CABIN AND ATTACHING THE CABIN BOTTOM AS SHOWN.**



**THE CENTER BODY CREATES A BIG RING AND THE SIDES FOLD DOWN LIKE WINGS.**

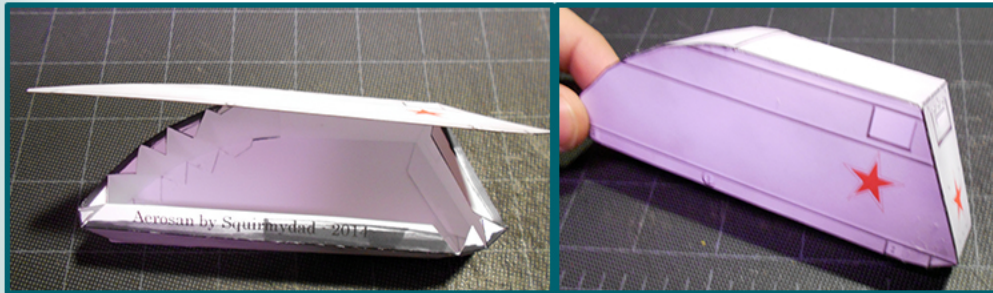

**THE STRUTS AND SKIDS ARE ALL FLAT FOLD-VER PIECES. BE AWARE THAT SEVERAL OF THE  
PIECES HAVE GLUE FLAPS THAT DON'T ATTACH TO EACH OTHER - SEE PHOTOS.  
BE SURE TO BEND A LITTLE CURVE INTO THE SKIDS ON EACH END.**

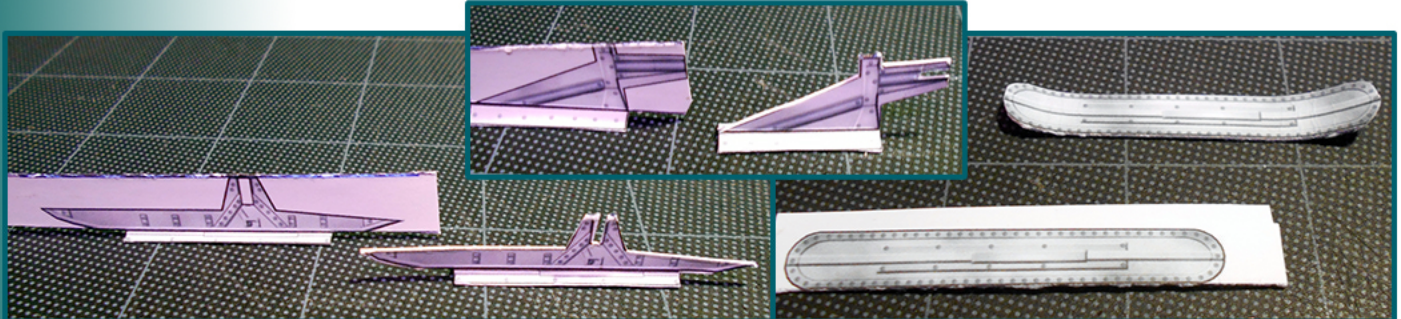

**THE STRUTS AND SKIDS ASSEMBLE AS SHOWN, REMEMBER TO MAKE BOTH LEFT AND RIGHT  
VERSIONS OF THE ASSEMBLIES.  
THE ASSEMBLIES ATTACH TO THE SIDES OF THE CABIN AND LEVEL WITH THE CABIN'S BOTTOM.  
THERE ARE SAIDEWAYS "V" MARKERS ON THE FINAL CABIN MODELS INDICATING  
THE PLACEMENT OF THE ASSEMBLIES.**

